

Vessel's Details:

Ship Type: Cargo
Year Built: 1997
Length x Breadth: 100 m X 16 m
DeadWeight: 5200 t
IMO: 9148790



MV Black Rhino

TONNAGE

- DWT: about 5,150mt (without tweendeck)
- GT/NT 3,838/2,035
- Suez GT/NT: 3,899.30/3,149.06

TYPE

- Self sustained multipurpose box shaped single deck container vessel except CEC Accord which is fully tween
- Fitted with bow thruster

DIMENSIONS

- LOA: 100.75m
- Lpp: 94.00m
- Beam: 16.00m
- Draft Summer SW: 6.19m
- Air draft less draft aft: 37.0m

CAPACITY

- Grain/Bale:
 - 6,681m³/235,955ft³
 - 750m³ in lower hold 2 x 15m² on platforms forward

HATCH

- One large hatch 61.94 x 12.62m
- The hatch covers are hydraulic end folding & piggy back type

HOLD

- One box-shaped doubleskinned cargo hold 61.94m long x 12.62m wide x 8.36m high
- 750m³ in lower hold, platforms forward 30m²
- The container platforms in the fore part of the hold should be noted
- CEC Accord is fitted with a complete set of loose pontoons adjustable in two heights. Erectable as transverse grainbulkhead at two different positions.

HOLD EQUIPMENT

- Electrical ventilation 6 airchanges per hour (based on empty hold)
- CEC Ace is fitted with CO₂ in hold
- The tanktop of CEC Ace is suitable for grab discharge

PERMISSIBLE LOADS

- Tanktop: 1.0mt/m²
- Hatch covers: 1.7mt/m²
- CEC Accord tweendeck 3mt/m²

STACK LOADS

- Tanktop: 72/90mt per stack of TEU/FEU
- Hatch covers: 28-40/39-60mt per stack of TEU/FEU

CRANES

- Two electro-hydraulic single cranes, each 40mt, outreach 23m, mounted in port side
- Built-in load measuring device in each crane

REEFER PLUGS

- 45 reefer plugs 380/220 volt

MAIN ENGINE

- CEC Action Wärtsila 8R32E 3,280kW/750rpm with gear (147rpm)
- CEC Ace/Accord Wärtsila 9R32E 3,680kW/750rpm with gear (147rpm)

GENERATORS

- 1 shaft generator 2 generators of 400kW each 1 emergency generator of 140kW

SPEED AND CONSUMPTION

- About 14 knots on 13,5mt IFO 180cst
- Port consumption idle: 0.9mt MGO
- Port consumption gear working: 1.5mt MGO
- Vessel burns MGO when maneuvering in shallow waters

TANK CAPACITY

- Heavy fuel oil (IFO): 490m³
- Gas oil: 93m³
- Fresh Water: about 57m³
- Water ballast:
 - CEC Action: 1,593m³
 - CEC Ace/Accord: about 1,750m³

CEC ACTION & CEC ACE

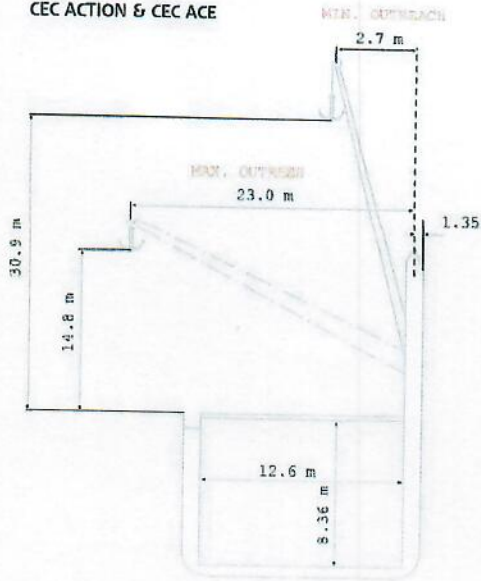

CEC ACCORD

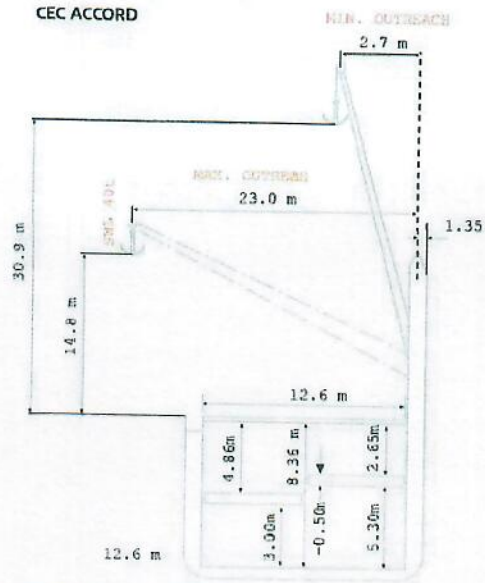

2 X 40MT
CAPACITY

| LOCATION | TEU | FEUS + TEUS |
|----------------|-----|-------------|
| Deck and hatch | 220 | 88 + 44 |
| Cargo hold | 144 | 69 + 6 |
| Total | 364 | 157 + 50 |

CONTAINER INTAKE

Container equipment

Vessel is fitted with a full set of container lashing equipment

| CONTAINER LOAD | | | | | |
|----------------|------|------|------|------|------|
| Homogeneous | 14mt | 16mt | 18mt | 20mt | 22mt |
| Intake TEUs | 226 | 220 | 207 | 192 | 186 |

1 HOLD CONFIGURATION

LOWER HOLD

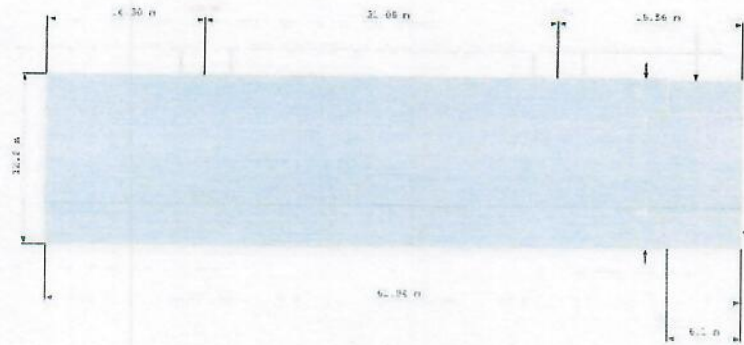

364 TEUS

